

Assembling the Elless Faucet Aerators

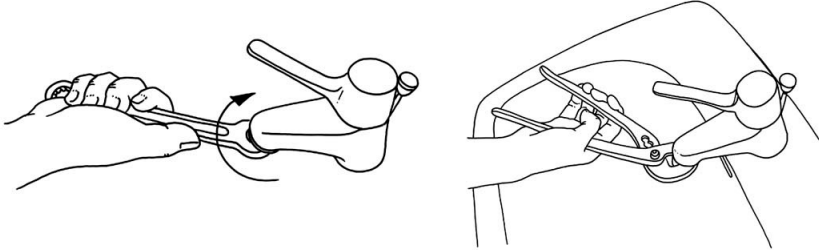

A. Start by dismantling the existing faucet

1. If there is a key handle on the faucet: use a 22 mm adjustable spanner. If not, use universal pliers. Do not squeeze the casing too hard, it might get disfigured and become difficult to loosen.
2. Make sure that there aren't any remains of the old gasket adhered to the spout.
3. Open the tap and let the water run for a few seconds to swill off any existing dirt.

B. Assembling the Elless Faucet Aerators

1. Put the Faucet Aerator in its place and tighten it manually as much as you can.
2. Open the tap and fasten the Faucet Aerator with a 22 mm adjustable spanner. You don't have to tighten it more than 1/4 – 1/2 rounds.

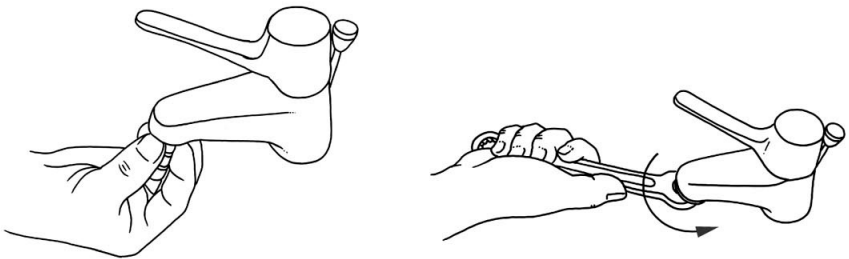

ELLESS[®]
WATER SAVING SYSTEM

LUNDBERG & SON
VVS-PRODUKTER AB

Kaggeholmsvägen 45, 122 60 Enskede
Ordertel: 08- 600 50 02 • Fax 08 - 600 50 07
E-post: info@elless.com
Försäljningskontor Halmstad: